

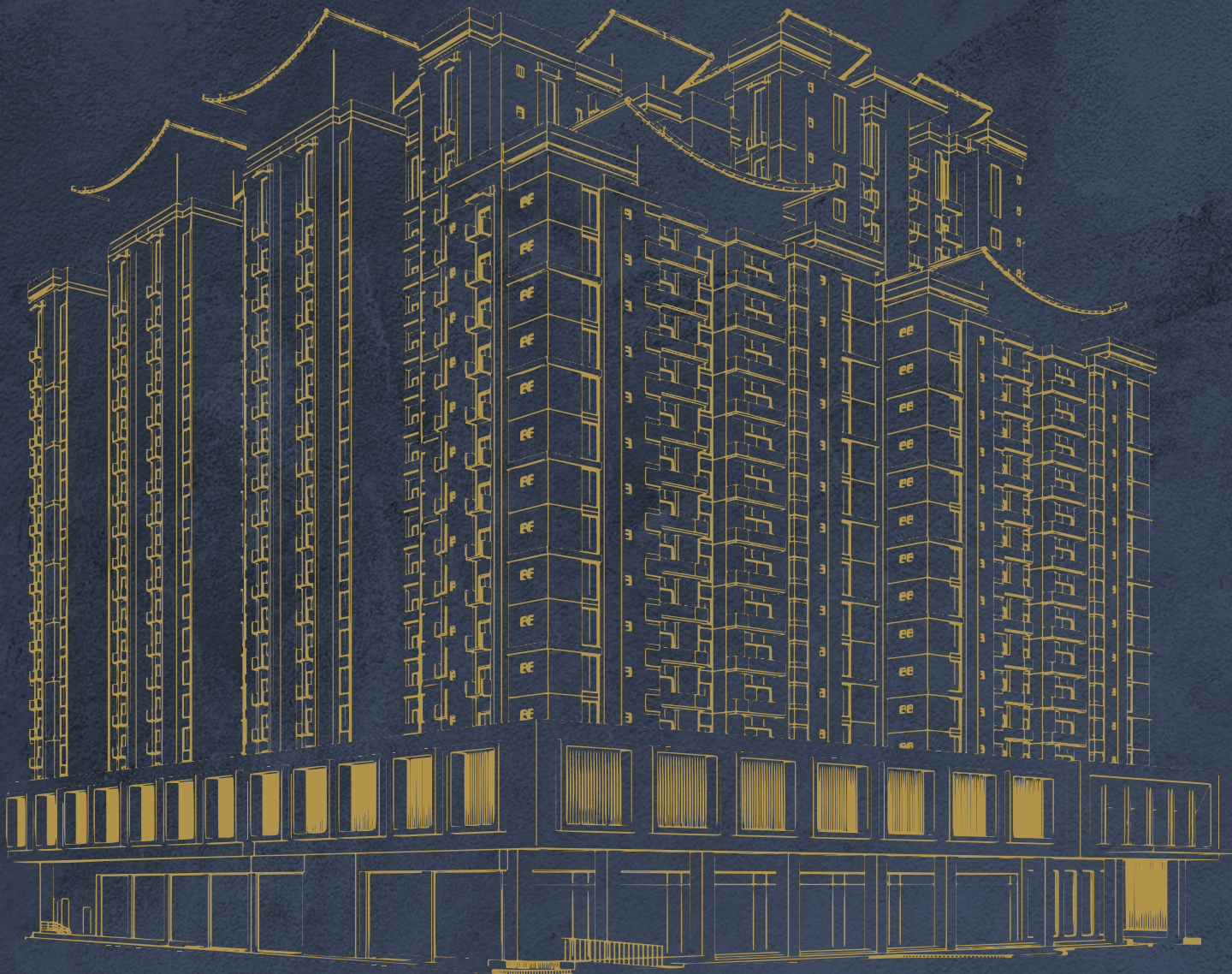

THE COURT

HEIGHTS







THE COURT  
HEIGHTS



THE COURT  
HEIGHTS





An epitome of spacious and luxurious living, The Court Heights is a new age residential project which assures a living beyond the best. Strategically located at national stadium road in front of NHS Karsaaz and in close proximity to National Stadium, Karachi. The Court Heights enjoys ease of connectivity to all major locations of the city.

• Millennium Mall	05 Minutes
• National Stadium	05 Minutes
• Shakra e Faisal	10 Minutes
• Aga Khan Hospital	10 Minutes
• University Of Karachi	20 Minutes
• Airport	20 minutes
• DHA	25 Minutes
• M9 Motorway	30 Minutes







THE COURT  
HEIGHTS

The Court Heights is all about raising the bar! The first impression counts and The Court Heights is truly mighty and majestic. Contemporary apartments at The Court Heights stand out tall and poised to surpass expectations.

The lavish residential project, situated at Callachi cooperative housing society, delights you with its ultra-luxury living standards, peaceful environment and central ambiance. Living here, unfolds the perfection of its planning. The project comprises spacious and well-ventilated apartments and lush green landscaped areas altogether.





The drop-off at the entrance creates an uplifting impression. A luxurious drop-off area provides a stunning entry statement to be enjoyed by the residents, visitors, and passers-by.

GRAND  
DROP OFF





THE GRAND  
WELCOME







Enjoy a royal welcome and service. The grand reception at the executive tower of The Court Heights is elegant and enchanting, which gives the hint of an exciting living experience. Enjoy the experience of living in a luxury community that makes you feel secure and relaxed with your loved ones. Welcome to your ultra-luxury apartment!

GRAND  
EXECUTIVE  
RECEPTION







After an exciting drop-off, residents and their guests will enter through a grand reception area. The beautifully crafted passageway opens out to a sophisticated lobby area equipped with express lifts, amenities, and facilities.



EXCLUSIVE  
PRIVATE  
LIFT



Welcome to your ultra-luxury apartment where you can experience the prestige of having an exclusive private lift with smart card access at the executive tower. This feature ensures you feel safe and at ease with your loved ones, making it a truly indulgent living experience.





A I R Y L I V I N G  
A R E A S



Spaciously designed super luxury apartments. Lavishly planned apartments offer more space than you are used to seeing. Framed by panoramic views of the city skyline, the living areas have been designed meticulously. The generous living space opens up to a vast landscaped terrace, creating a seamless transition between indoor and outdoor areas.







Every inch of the apartment has been designed thoughtfully; a drawing room is the epitome of understated luxury. The scale and proportions of the drawing room create an opulent oasis of your style statement.

COZY ROOM  
DRAWING ROOM





The apartment's layout is a harmonious combination of practicality, refined minimalism, and contemporary convenience. With a preference for an open kitchen design, the kitchen boasts a modern layout that's complemented by a range of high-quality fittings and fixtures.

OPEN PLAN  
KITCHEN







In The Court Heights, the layout defines the needs of the people and creates a blend of urban habitats. It ensures you achieve ultimate satisfaction with spacious and airy living spaces.



LUXURIOUS  
BEDROOM



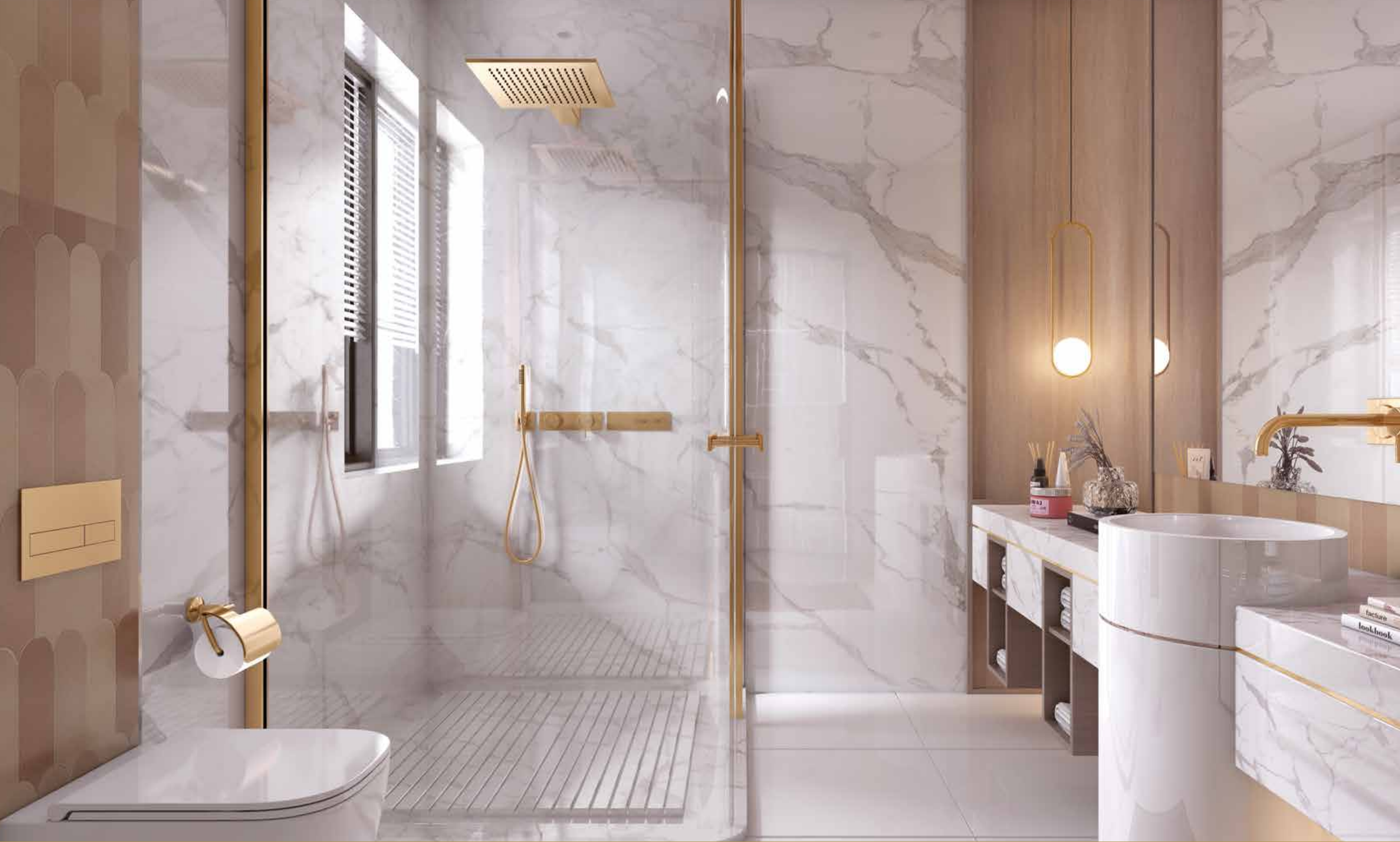

The bathrooms in this apartment embody streamlined minimalism for functionality. The design creates a serene atmosphere that is both luxurious and easy to maintain, with ample storage and high-quality sanitary fittings.

SPACIOUS  
BATHROOM





Your little ones deserve a cozy and inviting space to call their own, and a child's bedroom is the perfect place to create just that. The design of this bedroom is not only functional but also exudes a sense of luxury, reflecting your discerning taste. You can choose from a range of whimsical colors and fabrics to create a playful yet sophisticated atmosphere

K I D S  
B E D R O O M







## Terraces with a cityscape view

Spacious terrace offers stunning views of Karachi's cityscape and active life on the ground. Relax staring at horizon, or enjoy lively conversation with family.

P R I V A T E  
A P A R T M E N T  
T E R R A C E





EXPERIENCE  
THE  
HEIGHTS OF  
LUXURY







## Elevate yourself with Duplex Luxury

You'll feel on top of the world. The duplex at The Court Heights enjoy breathtaking views spanning from PNS Karsaaz to Karachi international Airport.

D U P L E X  
S U I T E





Welcome to the luxurious duplex rooftop experience, where modern design meets stunning city views and a refreshing swimming pool. Step out onto the rooftop and immerse yourself in the oasis above the city. Take a dip in the sparkling swimming pool while soaking up the sun and admiring the panoramic views. Whether you're relaxing with a book or entertaining friends, the rooftop is the perfect place to unwind. This rare opportunity to own a piece of paradise in the sky is not to be missed. Come experience the ultimate in urban living with the duplex rooftop experience, complete with a refreshing swimming pool.







  
THE COURT  
HEIGHTS

WORLD CLASS  
AMENITIES



S E R E N E  
L A N D S C A P I N G



The Green landscaped area on the podium is perfect for strolling, playing, and walking with your family and friends. A communal garden is a place to relax, rejoice and rejuvenate.







The jogging track on the podium level of our residential towers offers an unparalleled experience for fitness enthusiasts. Whether you're a seasoned runner or just starting out, the track provides a safe and convenient way to exercise without ever leaving the comfort of your building. With stunning views of the surrounding area, you'll feel invigorated as you jog, run or walk along the track. This is the perfect way to start your day or unwind after a long one. Take advantage of this exceptional feature and make fitness a part of your daily routine.

JOGGING  
TRACK



CHILDREN  
PLAY AREA



The outdoor kids play area at The Court Heights is a safe and exciting space for children to play, imagine, and indulge in physical activity. It's the perfect place for families to enjoy some quality time together, and for kids to develop important life skills in a fun and engaging way.

SEPARATE GYM  
FOR LADIES  
& GENTS



Enjoy your favorite workout or simply settle down with your aerobics routine. The gym at The Court Heights is well-equipped with state-of-the-art fitness equipment and perfect ambience to keep you involved in achieving ideal fitness you want.



COMMUNITY  
HALL



The Court Height's residents have superb facilities at their disposal. In addition to the world class recreational amenities, you can also celebrate events and entertain guests in the luxurious Community Hall with a large kitchen and abundant space.



A secluded and sophisticated prayer area has been planned for the residents so they could offers their prayers in a peaceful environment within the secure environment of the project.

PRAYER  
HALL



BEAUTY  
PARLOUR



Located at Common Tower-02, the beauty parlor is designed to provide a relaxing and rejuvenating double-heighted atmosphere, with tasteful decor, comfortable seating, and soothing music. Whether residents are looking to refresh their look before a special event, unwind after a long day at work, the beauty parlor is available within the secure premises of The Court Heights.



The modern football stadium adjacent to The Court Heights, offers a unique experience for residents with its stunning views of the stadium and the field. From the terraces, residents can witness the beauty and grandeur of the stadium and the surrounding area, providing a truly unique and unforgettable experience. With easy access to the stadium, experience the best of modern football whether you're a game fan or just starting to develop

FOOTBALL  
STADIUM



RETAILER INTO HEAVEN

The ground floor supermarket at The Court Heights provides residents with the ultimate convenience, offering a comprehensive range of products and services all in one location. Its modern and spacious layout makes shopping a breeze, with everything easy to locate. The supermarket has a vast selection of items, ensuring that customers can find whatever they need, from groceries to household essentials. Overall, The Court Heights supermarket provides a one-stop-shop experience for residents, making their shopping experience easy and hassle-free.





200+ exclusive  
basement  
parking  
slots for  
supermarket  
visitors



The provision of super-  
market on the ground  
floor is another land-  
mark that will ensure the  
availability of top quality,  
price-competitive  
products to the residents  
and visiting customers.

Based on modern construction methodology, The Court Heights has incorporated the transfer slab system to create a spacious, pillar less environment for a supermarket located on ground floor.







Every amenity of The Court Heights is meticulously planned to provide maximum ease and comfort for its residents. Multi-floor, hassle-free parking arrangements ensure provision of individual parking slots for the residents.



600+ exclusive basement parking slots for Residents



# PROJECT FEATURES





G R O U P O F  
C O M P A N I E S



One of the foremost construction groups of Pakistan, The Court Group has been engaged in real estate development for last 2 decades. Its business philosophy revolves around meeting quality standards, commitments and moving with the times by introducing innovative real estate investment options. Innovation lies at the very heart of the group's core values, and this enables the group to evolve in sync with changing world and setting new standards.



Cascade Builders & Developers is one of the leading real estate developers of Karachi. Ever since its inception the company has adapted to innovative building methods, eco-friendly initiatives and best practices of the industry. Our motto is to turn the dreams of our investors into reality.

T E A M

MEP  
Consultant:



Structural  
Consultant:



Architect:



Publicity  
Consultant:



B U I L D E R S &  
D E V E L O P E R S





With a proven track record in real estate development, we're pleased to showcase some of our foregoing projects.





# KEY PLAN





# BOOKING PLAN



## COMMON TOWER 1



## KEY PLAN



# BOOKING PLAN

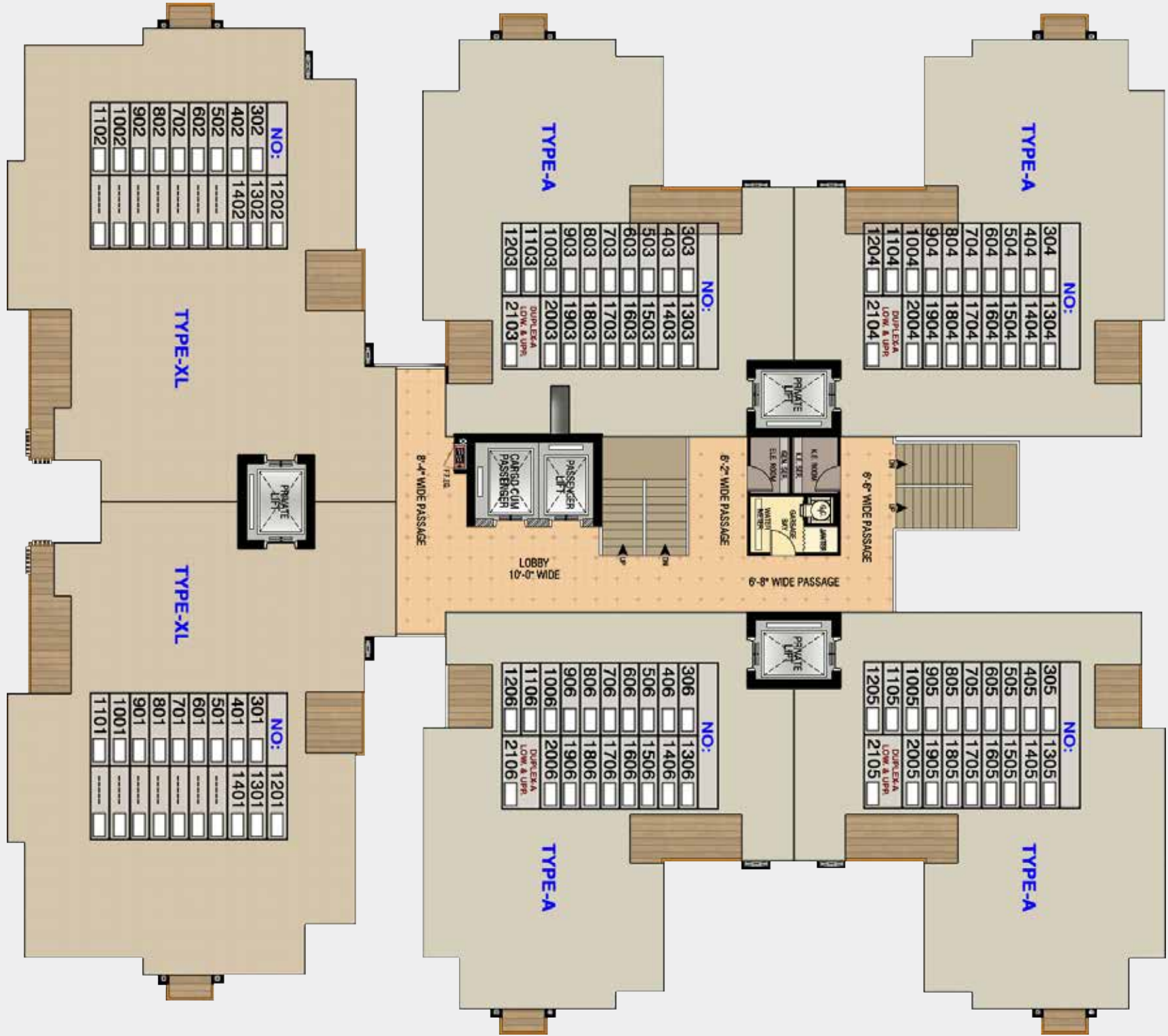

EXECUTIVE TOWER



KEY PLAN

COMMON TOWER 2



KEY PLAN

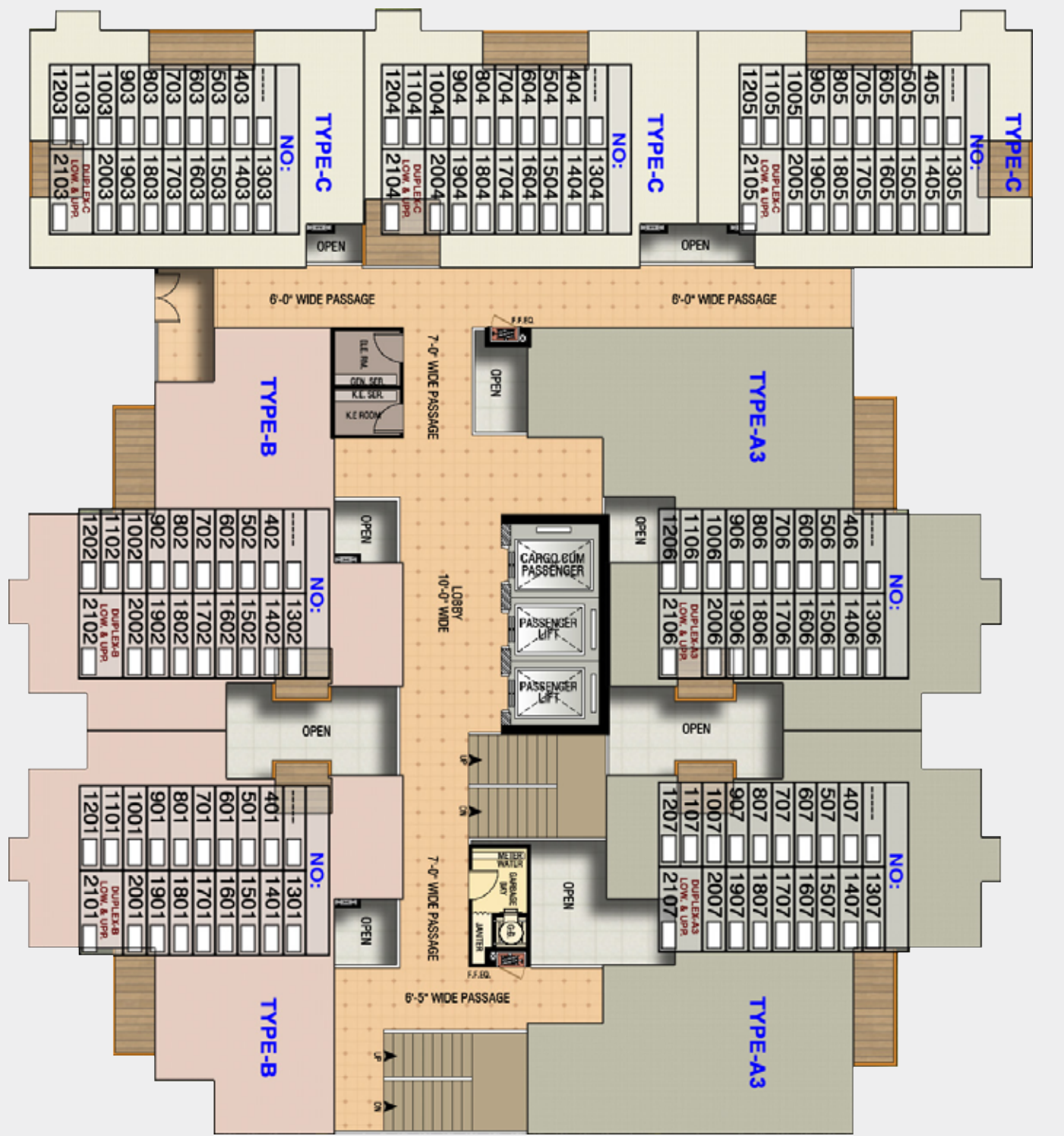

KEY PLAN



EXECUTIVE  
TOWER



TYPE - XL | 4 Bed D/L



TYPE - A1 | 3 Bed D/L

COMMON  
TOWER - 1





TYPE - B | 2 Bed D/L



TYPE - C | 2 Bed /L

COMMON  
TOWER - 2

COMMON  
TOWER - 2



THE COURT  
HEIGHTS







THE COURT  
HEIGHTS

Plot # 14 & 15, Callachi Co-Operative Housing Society, off: Stadium Road, (Dalmia), Gulshan-e-Iqbal, Karachi  
UAN: 021-111-777-666, [www.thecourtgroup.com.pk](http://www.thecourtgroup.com.pk)

DISCLAIMER

The Court Heights is constantly seeking ways to improve the specifications and design of the building and the modifications take place continually. While all reasonable care has been taken in preparing these architectural renderings, illustrations, pictures, photographs, and other graphic representations portrayed in this brochure, they are artistic impressions and may differ in some detail from the actual.