

**TYPE XL1 BT-1**  
**4 BED APARTMENT WITH MAID ROOM**



**Total Gross Area-----4029 SFT**  
a) Parking-----355 SFT  
b) Service & Circulation-----578SFT  
c) Total Net Area-----3095SFT  
    ➤ Semi Net -----348 SFT  
d) Net with Terrace/Roof Area-----2747 SFT  
    ➤ Net Apartment Area -----2150 SFT  
    ➤ Big Terrace-----597 SFT

**APARTMENT NUMBER**  
302



Payment Schedule	AMOUNT
Token	2,500,000.00
Booking After 30 Days of Token	2,500,000.00
Confirmation After 30 Days of Booking	2,500,000.00
Allocation After 30 Days of Confirmation	2,500,000.00
56 Monthly INSTALLMENT (56 X 610,000/-)	34,160,000.00
<b>BEFORE POSSESSION</b>	<b>4,840,000.00</b>
<b>Total</b>	<b>49,000,000.00</b>

**EXTRA CHARGES**

\*Corner View: RS 600,000.00/-  
Road View: RS 600,000.00/-

**TERMS AND CONDITIONS:**

- All Installment shall be paid by the allottee as per agreed schedule before 10th of each month.
- Extra charges shall be paid after 120 days of Booking amount (If applicable)
- Monthly installments shall be paid after 45 Days of Allocation Installment
- The unit Price does not include sales tax, government levies, ground rent, sub-Lease/ sale Deed execution charges, documentation charges, outer development charges connection and meter charges, deposit of electricity, gas, water & sewerage charges. Such charges including any miscellaneous expenses shall be paid by the allottee as and when demanded by the company
- The unit price includes only one allocated parking allotted with parking number
- The Booking / Allocation of unit shall remain provisional until the company receives full and final payment of unit. In case allottee defaults to make payment on regular interval as per agreed schedule; 5% of the unit price shall be non-refundable on cancellation
- Allottee shall abide by the terms and condition of the booking application form

**OPTIONAL**  
Additional parking:Rs2,500,000.00/-  
Servant Quarter : Rs.1,500,000/-



**TYPE XL1 BT-2**  
**4 BED APARTMENT WITH MAID ROOM**



- Total Gross Area-----4794 SFT**
- a) Parking-----355 SFT
  - b) Service & Circulation-----578SFT
  - c) Total Net Area-----3860 SFT
    - Semi Net -----348SFT
  - d) Net With Terrace/Roof Area----- 3512 SFT
    - Net Apartment Area -----2150 SFT
    - Big Terrace-----1362 SFT

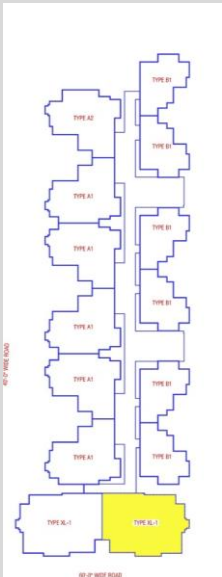

**APARTMENT NUMBER**  
**301**

Payment Schedule	AMOUNT
Token	2,800,000.00
Booking After 30 Days of Token	2,800,000.00
Confirmation After 30 Days of Booking	2,800,000.00
Allocation After 30 Days of Confirmation	2,800,000.00
56 Monthly INSTALLMENT (56 X 700,000/-)	39,200,000.00
<b>BEFORE POSSESSION</b>	<b>5,600,000.00</b>
<b>Total</b>	<b>56,000,000.00</b>

**EXTRA CHARGES**

West Open: RS 600,000.00/-  
\*Corner View: RS 600,000.00/-  
Road View: RS 600,000.00/-

**TERMS AND CONDITIONS:**

- All Installment shall be paid by the allottee as per agreed schedule before 10th of each month.
- Extra charges shall be paid after 120 days of Booking amount (If applicable)
- Monthly installments shall be paid after 45 Days of Allocation Installment
- The unit Price does not include sales tax, government levies, ground rent, sub-Lease/ sale Deed execution charges, documentation charges, outer development charges connection and meter charges, deposit of electricity, gas, water & sewerage charges. Such charges including any miscellaneous expenses shall be paid by the allottee as and when demanded by the company
- The unit price includes only one allocated parking allotted with parking number
- The Booking / Allocation of unit shall remain provisional until the company receives full and final payment of unit. In case allottee defaults to make payment on regular interval as per agreed schedule; 5% of the unit price shall be non-refundable on cancellation
- Allottee shall abide by the terms and condition of the booking application form

**OPTIONAL**  
Additional parking:Rs2,500,000.00/-  
Servant Quarter : Rs.1,500,000/-



**TYPE A1 BT-1**  
**3 BED APARTMENT WITH MAID ROOM**



**TYPE A1 BT-1**

- Total Gross Area-----3357 SFT**
- a) Parking-----355 SFT
- b) Service & Circulation-----427 SFT
- c) Total Net Area-----2575SFT
  - Semi Net -----257 SFT
- d) Net With Terrace/Roof-----2318 SFT
  - Net Apartment Area -----1589 SFT
  - Big Terrace-----729 SFT

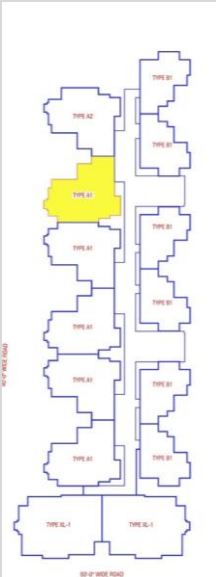

**APARTMENT NUMBER**  
307

Payment Schedule	AMOUNT
Token	2,800,000.00
Booking After 30 Days of Token	2,500,000.00
ALLOCATION After 30 Days of Booking	2,500,000.00
57 Monthly INSTALLMENT (57 X 480,000/-)	27,360,000.00
<b>BEFORE POSSESSION</b>	<b>3,840,000.00</b>
<b>Total</b>	<b>39,000,000.00</b>

**EXTRA CHARGES**

Road View: RS 600,000.00/-

**TERMS AND CONDITIONS:**

- All Installment shall be paid by the allottee as per agreed schedule before 10th of each month.
- Extra charges shall be paid after 120 days of Booking amount (If applicable)
- Monthly installments shall be paid after 45 Days of Allocation Installment
- The unit Price does not include sales tax, government levies, ground rent, sub-Lease/ sale Deed execution charges, documentation charges, outer development charges connection and meter charges, deposit of electricity, gas, water & sewerage charges. Such charges including any miscellaneous expenses shall be paid by the allottee as and when demanded by the company
- The unit price includes only one allocated parking allotted with parking number
- The Booking / Allocation of unit shall remain provisional until the company receives full and final payment of unit. In case allottee defaults to make payment on regular interval as per agreed schedule; 5% of the unit price shall be non-refundable on cancellation
- Allottee shall abide by the terms and condition of the booking application form

**OPTIONAL**  
Additional parking:Rs2,500,000.00/-  
Servant Quarter : Rs.1,500,000/-



**TYPE A1 BT-2**  
**3 BED APARTMENT WITH MAID ROOM**



**TYPE A1 BT-2**

- Total Gross Area-----3509 SFT**
- a) Parking-----355 SFT
- b) Service & Circulation-----427 SFT
- c) Total Net Area-----727 SFT
  - Semi Net -----257SFT
- d) Net with Terrace/Roof----- 2470 SFT
  - Net Apartment Area -----1589 SFT
  - Big Terrace-----881 SFT

APARTMENT NUMBER  
306

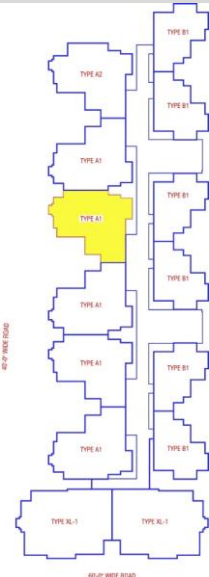

Payment Schedule	AMOUNT
Token	3,000,000.00
Booking After 30 Days of Token	2,500,000.00
ALLOCATION After 30 Days of Booking	2,600,000.00
57 Monthly INSTALLMENT (57 X 500,000/-)	28,500,000.00
BEFORE POSSESSION	4,000,000.00
<b>Total</b>	<b>40,600,000.00</b>

**EXTRA CHARGES**

Road View: RS 600,000.00/-

**TERMS AND CONDITIONS:**

- All Installment shall be paid by the allottee as per agreed schedule before 10th of each month.
- Extra charges shall be paid after 120 days of Booking amount (If applicable)
- Monthly installments shall be paid after 45 Days of Allocation Installment
- The unit Price does not include sales tax, government levies, ground rent, sub-Lease/ sale Deed execution charges, documentation charges, outer development charges connection and meter charges, deposit of electricity, gas, water & sewerage charges. Such charges including any miscellaneous expenses shall be paid by the allottee as and when demanded by the company
- The unit price includes only one allocated parking allotted with parking number
- The Booking / Allocation of unit shall remain provisional until the company receives full and final payment of unit. In case allottee defaults to make payment on regular interval as per agreed schedule; 5% of the unit price shall be non-refundable on cancellation
- Allottee shall abide by the terms and condition of the booking application form

OPTIONAL  
Additional parking:Rs2,500,000.00/-  
Servant Quarter : Rs.1,500,000/-



**TYPE A1 BT-3**  
**3 BED APARTMENT WITH MAID ROOM**



**TYPE A1 BT-3**

- Total Gross Area-----3661 SFT**
- a) Parking-----355 SFT
- b) Service & Circulation-----427 SFT
- c) Total Net Area-----2727 SFT
  - Semi Net-----257 SFT
- d) Net With Terrace/Roof-----2622 SFT
  - Net Apartment Area -----1589 SFT
  - Big Terrace-----1033 SFT

APARTMENT NUMBER  
305

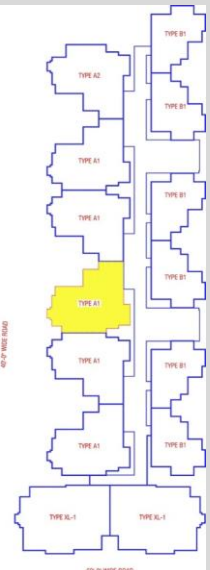

Payment Schedule	AMOUNT
Token	3,000,000.00
Booking After 30 Days of Token	3,000,000.00
ALLOCATION After 30 Days of Booking	2,500,000.00
57 Monthly INSTALLMENT (57 X 515,000/-)	29,355,000.00
BEFORE POSSESSION	4,245,000.00
<b>Total</b>	<b>42,100,000.00</b>

**EXTRA CHARGES**

Road View: RS 600,000.00/-

**TERMS AND CONDITIONS:**

- All Installment shall be paid by the allottee as per agreed schedule before 10th of each month.
- Extra charges shall be paid after 120 days of Booking amount (If applicable)
- Monthly installments shall be paid after 45 Days of Allocation Installment
- The unit Price does not include sales tax, government levies, ground rent, sub-Lease/ sale Deed execution charges, documentation charges, outer development charges connection and meter charges, deposit of electricity, gas, water & sewerage charges. Such charges including any miscellaneous expenses shall be paid by the allottee as and when demanded by the company
- The unit price includes only one allocated parking allotted with parking number
- The Booking / Allocation of unit shall remain provisional until the company receives full and final payment of unit. In case allottee defaults to make payment on regular interval as per agreed schedule; 5% of the unit price shall be non-refundable on cancellation
- Allottee shall abide by the terms and condition of the booking application form

**OPTIONAL**

Additional parking:Rs2,500,000.00/-  
Servant Quarter : Rs.1,500,000/-



**TYPE A1 BT-4**  
**3 BED APARTMENT WITH MAID ROOM**



**TYPE A1 BT-4**

- Total Gross Area-----3789 SFT**
- a) Parking-----355 SFT
- b) Service & Circulation-----427 SFT
- 
- c) Total Net Area----- 3007 SFT
  - Semi Net -----257 SFT
- d) Net With Terrace/Roof-----2750 SFT
  - Net Apartment Area -----1589 SFT
  - Big Terrace-----1161 SFT

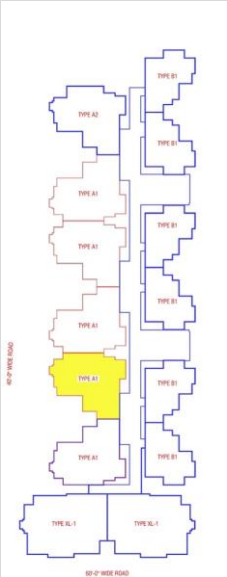

APARTMENT NUMBER  
304

Payment Schedule	AMOUNT
Token	3,000,000.00
Booking After 30 Days of Token	3,000,000.00
ALLOCATION After 30 Days of Booking	2,600,000.00
57 Monthly INSTALLMENT (57 X 535,000/-)	30,495,000.00
BEFORE POSSESSION	4,305,000.00
<b>Total</b>	<b>43,400,000.00</b>

**EXTRA CHARGES**

Road View: RS 600,000.00/-

**TERMS AND CONDITIONS:**

- All Installment shall be paid by the allottee as per agreed schedule before 10th of each month.
- Extra charges shall be paid after 120 days of Booking amount (If applicable)
- Monthly installments shall be paid after 45 Days of Allocation Installment
- The unit Price does not include sales tax, government levies, ground rent, sub-Lease/ sale Deed execution charges, documentation charges, outer development charges connection and meter charges, deposit of electricity, gas, water & sewerage charges. Such charges including any miscellaneous expenses shall be paid by the allottee as and when demanded by the company
- The unit price includes only one allocated parking allotted with parking number
- The Booking / Allocation of unit shall remain provisional until the company receives full and final payment of unit. In case allottee defaults to make payment on regular interval as per agreed schedule; 5% of the unit price shall be non-refundable on cancellation
- Allottee shall abide by the terms and condition of the booking application form

OPTIONAL  
Additional parking:Rs2,500,000.00/-  
Servant Quarter : Rs.1,500,000/-



**TYPE A1 BT-5**  
**3 BED APARTMENT WITH MAID ROOM**



**TYPE A1 BT-5**

- Total Gross Area-----3874 SFT**
- a) Parking-----355 SFT
- b) Service & Circulation-----427 SFT
- c) Total Net Area-----3092 SFT
  - Semi Net -----257 SFT
- d) Net With Terrace/Roof-----2835 SFT
  - Net Apartment Area -----1589 SFT
  - Big Terrace-----1246 SFT

**APARTMENT NUMBER**  
303

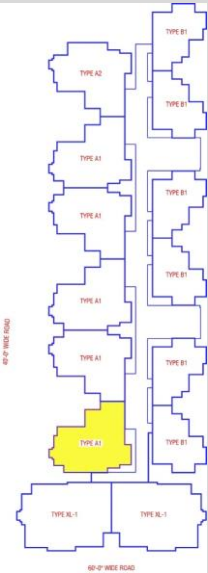

Payment Schedule	AMOUNT
Token	3,000,000.00
Booking After 30 Days of Token	3,000,000.00
ALLOCATION After 30 Days of Booking	2,800,000.00
57 Monthly INSTALLMENT (57 X 540,000/-)	30,780,000.00
<b>BEFORE POSSESSION</b>	<b>4,420,000.00</b>
<b>Total</b>	<b>44,000,000.00</b>

**EXTRA CHARGES**

Road View: RS 600,000.00/-

**TERMS AND CONDITIONS:**

- All Installment shall be paid by the allottee as per agreed schedule before 10th of each month.
- Extra charges shall be paid after 120 days of Booking amount (If applicable)
- Monthly installments shall be paid after 45 Days of Allocation Installment
- The unit Price does not include sales tax, government levies, ground rent, sub-Lease/ sale Deed execution charges, documentation charges, outer development charges connection and meter charges, deposit of electricity, gas, water & sewerage charges. Such charges including any miscellaneous expenses shall be paid by the allottee as and when demanded by the company
- The unit price includes only one allocated parking allotted with parking number
- The Booking / Allocation of unit shall remain provisional until the company receives full and final payment of unit. In case allottee defaults to make payment on regular interval as per agreed schedule; 5% of the unit price shall be non-refundable on cancellation
- Allottee shall abide by the terms and condition of the booking application form

**OPTIONAL**  
Additional parking:Rs2,500,000.00/-  
Servant Quarter : Rs.1,500,000/-



**TYPE A-2 BT**  
**3 BED APARTMENT WITH MAID ROOM**



**TYPE A2 BT**

- Total Gross Area-----3951 SFT**
- a) Parking-----355 SFT
- b) Service & Circulation-----434 SFT
- c) Total Net Area-----3162 SFT
  - Semi Net -----261 SFT
- d) Net With Terrace/Roof----- 2901 SFT
  - Net Apartment Area -----1612 SFT
  - Big Terrace-----1289 SFT

APARTMENT NUMBER  
308

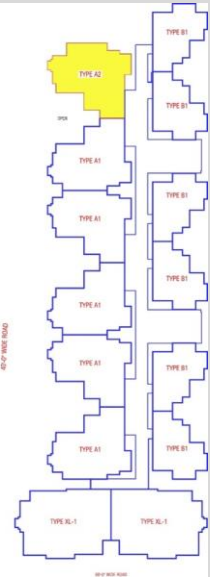

Payment Schedule	AMOUNT
Token	3,000,000.00
Booking After 30 Days of Token	3,000,000.00
ALLOCATION After 30 Days of Booking	3,000,000.00
57 Monthly INSTALLMENT (57 X 550,000/-)	31,350,000.00
BEFORE POSSESSION	4,650,000.00
<b>Total</b>	<b>45,000,000.00</b>

**EXTRA CHARGES**

West Open: RS 600,000.00/-  
\*Corner View: RS 600,000.00/-  
Road View: RS 600,000.00/-

**TERMS AND CONDITIONS:**

- All Installment shall be paid by the allottee as per agreed schedule before 10th of each month.
- Extra charges shall be paid after 120 days of Booking amount (If applicable)
- Monthly installments shall be paid after 45 Days of Allocation Installment
- The unit Price does not include sales tax, government levies, ground rent, sub-Lease/ sale Deed execution charges, documentation charges, outer development charges connection and meter charges, deposit of electricity, gas, water & sewerage charges. Such charges including any miscellaneous expenses shall be paid by the allottee as and when demanded by the company
- The unit price includes only one allocated parking allotted with parking number
- The Booking / Allocation of unit shall remain provisional until the company receives full and final payment of unit. In case allottee defaults to make payment on regular interval as per agreed schedule; 5% of the unit price shall be non-refundable on cancellation
- Allottee shall abide by the terms and condition of the booking application form

OPTIONAL  
Additional parking:Rs2,500,000.00/-  
Servant Quarter : Rs.1,500,000/-







APARTMENT WITH PRIVATE LIFT



**TYPE XL BT-2**

- Total Gross Area-----3818 SFT
- a) Parking-----355 SFT
- b) Service & Circulation-----590 SFT
- c) Total Net Area-----2873 SFT
  - Semi Net -----161 SFT
- d) Net With Terrace/Roof-----2712 SFT
  - Net Apartment Area -----2195 SFT
  - Big Terrace-----517 SFT

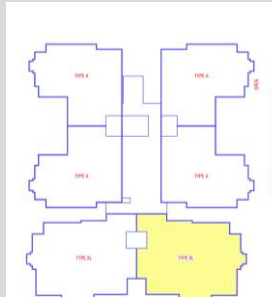

APARTMENT NUMBER  
301

TYPE XL BT-2  
4 BED APARTMENT WITH MAID ROOM

Payment Schedule	AMOUNT
Token	2,800,000.00
Booking After 1 Months of Token	2,800,000.00
Confirmation After 3 Months of Booking	2,800,000.00
Allocation After 4 Months of Confirmation	2,800,000.00
60 Monthly INSTALLMENT( 60 X 645,000/-) After 4 Month of Allocation	38,700,000.00
<b>BEFORE POSSESSION</b>	<b>5,600,000.00</b>
<b>Total</b>	<b>55,500,000.00</b>

EXTRA CHARGES

- West Open: RS 600,000/-
- \*Corner View: RS 600,000/-
- \*Road View: RS 600,000/-

TERMS AND CONDITIONS:

- All Installment shall be paid by the allottee as per agreed schedule before 10th of each month.
- Extra charges shall be paid after 120 days of Booking amount (If applicable)
- Monthly installments shall be paid after 45 Days of Allocation Installment
- The unit Price does not include sales tax, government levies, ground rent, sub-Lease/ sale Deed execution charges, documentation charges, outer development charges connection and meter charges, deposit of electricity, gas, water & sewerage charges. Such charges including any miscellaneous expenses shall be paid by the allottee as and when demanded by the company
- The unit price includes only one allocated parking allotted with parking number
- The Booking / Allocation of unit shall remain provisional until the company receives full and final payment of unit. In case allottee defaults to make payment on regular interval as per agreed schedule; 5% of the unit price shall be non-refundable on cancellation
- Allottee shall abide by the terms and condition of the booking application form

OPTIONAL

- Additional parking:Rs2,500,000.00/-
- Servant Quarter : Rs.1,500,000/-



APARTMENT WITH PRIVATE LIFT



**TYPE A BT-1**

- Total Gross Area-----3659 SFT
- a) Parking-----355 SFT
- b) Service & Circulation-----458 SFT
- c) Total Net Area-----2846 SFT
  - Semi Net -----125 SFT
- d) Net With Terrae/Roof -----2721 SFT
  - Net Apartment Area -----1701 SFT
  - Big Terrace-----1020 SFT

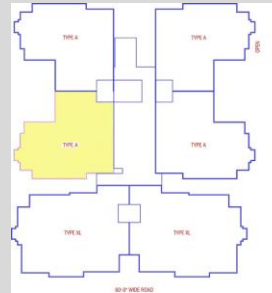

APARTMENT NUMBER  
303

TYPE A BT-1  
3 BED APARTMENT WITH MAID ROOM

Payment Schedule	AMOUNT
Token	2,500,000.00
Booking After 1 Months of Token	2,500,000.00
Confirmation After 3 Months of Booking	2,500,000.00
Allocation After 4 Months of Confirmation	2,500,000.00
60 Monthly INSTALLMENT( 60 X 575,000/-) After 4 Month of Allocation	34,500,000.00
<b>BEFORE POSSESSION</b>	<b>4,800,000.00</b>
<b>Total</b>	<b>49,300,000.00</b>

Landscape View: RS 600,000/-

EXTRA CHARGES

TERMS AND CONDITIONS:

- All Installment shall be paid by the allottee as per agreed schedule before 10th of each month.
- Extra charges shall be paid after 120 days of Booking amount (If applicable)
- Monthly installments shall be paid after 45 Days of Allocation Installment
- The unit Price does not include sales tax, government levies, ground rent, sub-Lease/ sale Deed execution charges, documentation charges, outer development charges connection and meter charges, deposit of electricity, gas, water & sewerage charges. Such charges including any miscellaneous expenses shall be paid by the allottee as and when demanded by the company
- The unit price includes only one allocated parking allotted with parking number
- The Booking / Allocation of unit shall remain provisional until the company receives full and final payment of unit. In case allottee defaults to make payment on regular interval as per agreed schedule; 5% of the unit price shall be non-refundable on cancellation
- Allottee shall abide by the terms and condition of the booking application form

OPTIONAL

Additional parking:Rs2,500,000.00/-  
Servant Quarter : Rs.1,500,000/-



APARTMENT WITH PRIVATE LIFT



**TYPE A BT-2**

- Total Gross Area-----3218 SFT
- a) Parking-----355 SFT
- b) Service & Circulation-----458 SFT
- c) Total Net Area-----2405 SFT
  - Semi Net -----125 SFT
- d) Net With Terrace/Roof-----2280 SFT
  - Net Apartment Area -----1701 SFT
  - Big Terrace-----579 SFT

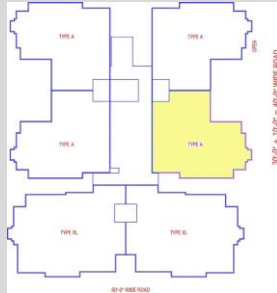

APARTMENT NUMBER  
306

TYPE A BT-2  
3 BED APARTMENT WITH MAID ROOM

Payment Schedule	AMOUNT
Token	2,250,000.00
Booking After 1 Months of Token	2,250,000.00
Confirmation After 3 Months of Booking	2,250,000.00
Allocation After 4 Months of Confirmation	2,250,000.00
60 Monthly INSTALLMENT( 60 X 525,000/-) After 4 Month of Allocation	31,500,000.00
<b>BEFORE POSSESSION</b>	<b>4,500,000.00</b>
<b>Total</b>	<b>45,000,000.00</b>

EXTRA CHARGES

West Open: RS 600,000/-  
\*Road View: RS 600,000/-

TERMS AND CONDITIONS:

- All Installment shall be paid by the allottee as per agreed schedule before 10th of each month.
- Extra charges shall be paid after 120 days of Booking amount (If applicable)
- Monthly installments shall be paid after 45 Days of Allocation Installment
- The unit Price does not include sales tax, government levies, ground rent, sub-Lease/ sale Deed execution charges, documentation charges, outer development charges connection and meter charges, deposit of electricity, gas, water & sewerage charges. Such charges including any miscellaneous expenses shall be paid by the allottee as and when demanded by the company
- The unit price includes only one allocated parking allotted with parking number
- The Booking / Allocation of unit shall remain provisional until the company receives full and final payment of unit. In case allottee defaults to make payment on regular interval as per agreed schedule; 5% of the unit price shall be non-refundable on cancellation
- Allottee shall abide by the terms and condition of the booking application form

OPTIONAL

Additional parking:Rs2,500,000.00/-  
Servant Quarter : Rs.1,500,000/-



APARTMENT WITH PRIVATE LIFT



**TYPE A BT-3**

- Total Gross Area-----3378 SFT
- a) Parking-----355 SFT
- b) Service & Circulation-----458 SFT
- c) Total Net Area-----2565 SFT
  - Semi Net -----125 SFT
- d)Net With Terrace/Roof-----2440 SFT
  - Net Apartment Area -----1701 SFT
  - Big Terrace-----739 SFT

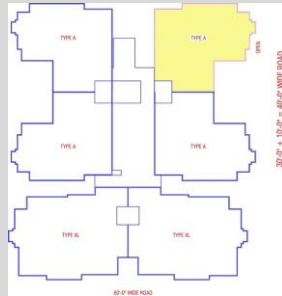

APARTMENT NUMBER  
305

TYPE A BT-3  
3 BED APARTMENT WITH MAID ROOM

Payment Schedule	AMOUNT
Token	2,300,000.00
Booking After 1 Months of Token	2,300,000.00
Confirmation After 3 Months of Booking	2,300,000.00
Allocation After 4 Months of Confirmation	2,300,000.00
60 Monthly INSTALLMENT( 60 X 545,000/-) After 4 Month of Allocation	32,700,000.00
<b>BEFORE POSSESSION</b>	<b>4,600,000.00</b>
<b>Total</b>	<b>46,500,000.00</b>

EXTRA CHARGES

- West Open: RS 600,000/-
- \*Corner View: RS 600,000/-
- \*Road View: RS 600,000/-
- Landscape View: RS 600,000/-

TERMS AND CONDITIONS:

- All Installment shall be paid by the allottee as per agreed schedule before 10th of each month.
- Extra charges shall be paid after 120 days of Booking amount (If applicable)
- Monthly installments shall be paid after 45 Days of Allocation Installment
- The unit Price does not include sales tax, government levies, ground rent, sub-Lease/ sale Deed execution charges, documentation charges, outer development charges connection and meter charges, deposit of electricity, gas, water & sewerage charges. Such charges including any miscellaneous expenses shall be paid by the allottee as and when demanded by the company
- The unit price includes only one allocated parking allotted with parking number
- The Booking / Allocation of unit shall remain provisional until the company receives full and final payment of unit. In case allottee defaults to make payment on regular interval as per agreed schedule; 5% of the unit price shall be non-refundable on cancellation
- Allottee shall abide by the terms and condition of the booking application form

OPTIONAL

Additional parking:Rs2,500,000.00/-  
Servant Quarter : Rs.1,500,000/-



APARTMENT WITH PRIVATE LIFT



**TYPE A BT-4**

- Total Gross Area-----3849 SFT
- a) Parking-----355 SFT
- b) Service & Circulation-----458 SFT
- c) Total Net Area-----3036 SFT
  - Semi Net -----125 SFT
- d) Net With Terrace/Roof-----2911 SFT
  - Net Apartment Area -----1701 SFT
  - Big Terrace-----1210 SFT

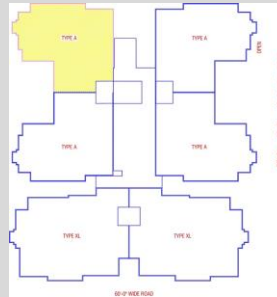

APARTMENT NUMBER  
304

TYPE A BT-4  
3 BED APARTMENT WITH MAID ROOM

Payment Schedule	AMOUNT
Token	2,625,000.00
Booking After 1 Months of Token	2,625,000.00
Confirmation After 3 Months of Booking	2,625,000.00
Allocation After 4 Months of Confirmation	2,625,000.00
60 Monthly INSTALLMENT( 60 X 590,000/-) After 4 Month of Allocation	35,400,000.00
<b>BEFORE POSSESSION</b>	<b>5,100,000.00</b>
<b>Total</b>	<b>51,000,000.00</b>

\*Corner View: RS 600,000/-  
Landscape View: RS 600,000/-

EXTRA CHARGES

TERMS AND CONDITIONS:

- All Installment shall be paid by the allottee as per agreed schedule before 10th of each month.
- Extra charges shall be paid after 120 days of Booking amount (If applicable)
- Monthly installments shall be paid after 45 Days of Allocation Installment
- The unit Price does not include sales tax, government levies, ground rent, sub-Lease/ sale Deed execution charges, documentation charges, outer development charges connection and meter charges, deposit of electricity, gas, water & sewerage charges. Such charges including any miscellaneous expenses shall be paid by the allottee as and when demanded by the company
- The unit price includes only one allocated parking allotted with parking number
- The Booking / Allocation of unit shall remain provisional until the company receives full and final payment of unit. In case allottee defaults to make payment on regular interval as per agreed schedule; 5% of the unit price shall be non-refundable on cancellation
- Allottee shall abide by the terms and condition of the booking application form

OPTIONAL

Additional parking:Rs2,500,000.00/-  
Servant Quarter : Rs.1,500,000/-

